

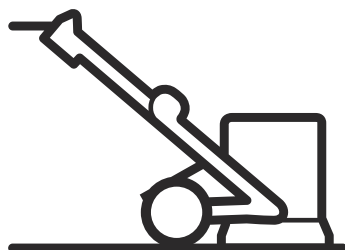

# Husqvarna®



PG 510

EN Operator's manual

2-19

**KEVMOR**  
TRADE SUPPLIES

**Kevmor Trade Supplies**

11 Belmont Avenue, Belmont WA 6104

P: 08 9277 7177

E: [sales@kevmor.com.au](mailto:sales@kevmor.com.au)

W: [kevmor.com.au](http://kevmor.com.au)

---

## Contents

---

Introduction.....	2	Troubleshooting.....	14
Safety.....	4	Transportation and storage.....	15
Operation.....	7	Technical data.....	17
Maintenance.....	13	EC Declaration of Conformity.....	19

---

## Introduction

---

### Product description

The product is a power grinder for concrete surfaces of different hardness. The grind range is from rough surfaces through to smoother finish.

For example, the product has these functions:

- A frame that can be folded for easier transport.
- A grinding head cover that adjusts the movement to the surface layer.
- The grinding head has 3 grinding discs. Full set is with 6 segments on each grinding disc.
- Resin holder, a holder for plastic bonded diamond tools.

- Available in 1- or 3-phase.
- A grind width of 515 mm.

### Intended use

Use the product to grind concrete surfaces with different hardness such as terazzo and stone tiles.

The product is used for light commercial operations at private properties and small commercial spaces.



**WARNING:** Do not use the product for other tasks.

---

## Product overview

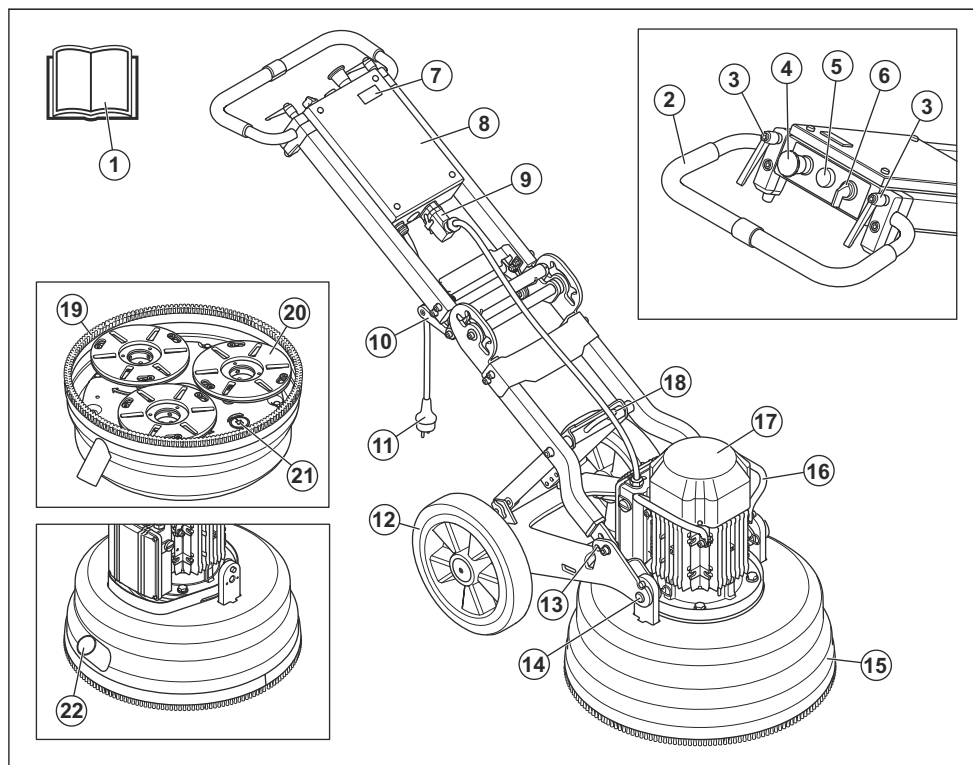

1. Operator's manual
2. Handle/Handlebar
3. Lock knobs for handlebar adjustment
4. Emergency stop
5. Overload lamp
6. ON/OFF switch
7. Hour meter
8. Electrical enclosure
9. Connection for motor cable
10. Angle joint handle
11. Power plug
12. Rubber wheels
13. Lock function
14. Lock bolt to attach the motor/grinding head
15. Grinding head cover
16. Lift handle, motor
17. Electric motor
18. Lifting eye
19. Brush strip
20. Tool plate - 3 grinding discs
21. Bottom/lower plate - grinding head

22. Connection, vacuum hose

### Symbols on the product



**WARNING:** Not careful or incorrect use can result in injury or death to the operator or others.



Read the manual carefully and make sure that you understand the instructions before you use the product.



Always put on hearing protection, eye protection and breathing protection.



**WARNING!** The dust can cause breathing problems. Use breathing protection. Do not breathe exhaust fumes. Always make sure that there is good airflow.



This product is in compliance with applicable EC directives.

**Note:** Other symbols/decals on the product refer to special certification requirements for some markets.

## Product liability

As referred to in the product liability laws, we are not liable for damages that our product causes if:

- the product is incorrectly repaired.
- the product is repaired with parts that are not from the manufacturer or not approved by the manufacturer.
- the product has an accessory that is not from the manufacturer or not approved by the manufacturer.
- the product is not repaired at an approved service center or by an approved authority.

## Safety

### Safety definitions

Warnings, cautions and notes are used to point out specially important parts of the manual.



**WARNING:** Used if there is a risk of injury or death for the operator or bystanders if the instructions in the manual are not obeyed.



**CAUTION:** Used if there is a risk of damage to the product, other materials or the adjacent area if the instructions in the manual are not obeyed.

**Note:** Used to give more information that is necessary in a given situation.



**WARNING:** Overexposure to vibration can cause circulatory damage or nerve damage to persons with decreased blood circulation. Get medical aid if you have symptoms of overexposure to vibration. These symptoms include numbness, loss of feeling, tingling, pricking, pain, loss of strength, changes in skin color or condition. These symptoms usually show in the fingers, hands or wrists.

### General safety instructions



**WARNING:** Read the warning instructions that follow before you use the product. Save all warnings and instructions. Refer to the warnings and instructions for future work, if it is necessary.

- The safety section gives basic directions on how to use the product correctly. This information is not an alternative for professional knowledge and experience. If you are in a situation where you do not feel safe, stop and get professional support. Speak to your dealer, service agent or an operator with experience. Do not try a task where you do not feel sure.
- Keep work area clean and bright, this will decrease the risk of accidents.

### Safety instructions for operation



**WARNING:** Read the warning instructions that follow before you use the product. Save all warnings and instructions for future operations.

- Only use the product for operations that are given in this manual. Refer to *Intended use on page 2*.
- Use personal protective equipment. Refer to *Personal protective equipment on page 5*.
- Do not go away from the product when the motor is on.
- Connect the motor cable to the electrical enclosure before you connect the plug.
- Do not let other operators use the product if they have not read and understood the contents of this operators manual.
- Only start the product with the brush strip attached. Brush strip must seal tightly to the surface, especially during dry surface operations.
- Make sure that the brush strip is not damaged and is clean. Replace damaged brush strip.
- Keep the motor on until the fan comes to a complete stop.
- Lift the grinding head if a check of the start procedure is necessary.
- Only start the product when the grinding head is put on the surface.
- Make sure that only approved persons are in the work area.
- Do not use the product in areas where fire or explosions can occur.
- Always disassemble the diamond tool after each operation.
- Make sure that the tool plate does not rotate if you lift up the product. The tool plate continues to rotate for a while after the motor stops.
- When you remove diamond tools, let the product become cool and use protective gloves. Diamond tools are very hot after use.

- Make sure to connect the product to a dust extractor for removal of the dust.
- Make sure that the product is assembled correctly.
- To lift the product always use the lifting eye of the product.
- Do not use the product if there are signs of damage.
- Only start the product when the grinding head touches the surface, unless you do a check of the ON/OFF switch.
- Only operate the product from behind with your 2 hands on the handle.
- Do not operate the product unless you receive training before use. Make sure that all operators receive training.
- Make sure that only approved persons are in the work area, because there is a risk of serious injury.
- Make sure that clothing, long hair and jewelry do not get caught in moving parts.
- Make sure that you are in a safe and stable position during operation.
- Sudden appearance of persons and animals can prevent safe operation of the product. Always operate the product carefully and be prepared to stop the product if it is necessary.
- Do not let children use or come near the product.
- Make sure that there is always one more person near when you use the product. If an accident occurs, you can receive help when it is necessary.
- Do not operate this product when you are tired, ill, or if you use alcohol, drugs or medicine. This can decrease your vision, your judgment or your coordination.
- Do not use a product that has been changed from its factory specification.
- Always use approved accessories. Speak to your dealer for more information.
- Always use approved hearing protection while you operate the product. Noise for a long period can cause noise-induced hearing loss.
- The product makes dust and fumes that contain dangerous chemicals. Use an approved breathing protection.
- Use boots with steel toe-caps and non-slip soles.
- Make sure that you have a first aid kit near.
- Sparks can occur when you operate the product. Make sure that you have a fire extinguisher near.

## Electrical safety



**WARNING:** There is always a risk of shocks from electrical products. Do not use the product in bad weather conditions. Do not touch lightning conductors and metal objects. Always use the product as given in this operator's manual to prevent injury.



**CAUTION:** The product obeys the requirements in EN61000-3-11 and is a subject for conditional connection to the power mains. Speak with the supply authority for instructions on how to connect the product.

Only connect the product to the power mains with resistance lower than 0.28 Ω. Get the interface point of the system resistance from the supply authority.

If the power mains has higher system resistance, short voltage drop can occur when the product is started. This can influence the operation of other products, for example flicker on the lights.

## Personal protective equipment



**WARNING:** Read the warning instructions that follow before you use the product.

- Always use correct personal protective equipment when you operate the product. The personal protective equipment does not erase the risk of injury. The personal protective equipment decreases the grade of injury if an accident occurs. Let your dealer help you select the right equipment.
- Use approved eye protection while you operate the product.
- Do not use loose, heavy and not applicable clothing. Use clothes that let you move freely.
- Use approved protective gloves that enables a solid hold.
- Use rubber protective gloves that prevents skin irritation from wet concrete.
- Use an approved protective helmet.
- Make sure that the power, fuse and mains voltage are the same as the voltage shown on the rating plate of the product.
- Always stop the product before you disconnect the power plug.
- Do not use the product if the cord or plug is damaged. Hand it in to an approved service center for repair. A damaged cable can cause serious injury and death.
- Use the cord correctly. Do not use the cord to move, pull or disconnect the product. Hold the plug to disconnect the power cord.
- Do not operate the product in water depths where the equipment of the product gets wet. The equipment can be damaged and the product can become live and cause injury.
- Do not get more moisture into the product than that is supplied by the water system. Prevent rain to come in touch with the product. Water that enters a power tool increases the risk of electrical shock.
- Always have the power cord disconnected when you connect or disconnect the connection for the motor cable and the electrical enclosure.

## Grounded product instructions



**WARNING:** Incorrect connection can result in electrical shock. Speak to an approved electrician if you are not sure if the product is correctly grounded.

Do not change the power plug from its factory specification. If the power plug is not correct for the mains outlet, let an approved electrician install a correct mains outlet. Obey local regulations and laws.

If you do not fully understand the instructions about the grounded product, speak to an approved electrician.

The product has a grounded cord and power plug. Always connect the product to a grounded mains outlet. This decreases the risk of electrical shock if there is a malfunction.

Do not use adapters with the product.

## Extension cables

- The mark on the extension cable must be the same or higher than the value written on the rating plate of the product.
- Use grounded extension cables.
- When you operate a power tool outdoor, use extension cable that is applicable for outdoor operation. Use of a power cord applicable for outdoor operations decreases the risk of electrical shock.
- Keep the connection to the extension cable dry and off the ground.
- Keep cable away from heat, oil, sharp edges or moving parts. Damaged or too large cable increases the risk of electrical shock.
- Check that the cables are not damaged and in good condition. Do not use the product if a cable is damaged. Let an approved service center repair the product.
- To prevent overheating, do not use the extension cable while it is folded.
- Make sure that the power cord is behind you when you use the product. This is to prevent damage to the power cord.
- If you use an extension cable, use only approved extension cables with sufficient length.

## Safety devices on the product



**WARNING:** Read the warning instructions that follow before you use the product.

- Do not use a product with defective safety devices.
- Do a check of the safety devices regularly, refer to *Daily maintenance on page 13*. If the safety devices

are defective, speak to your Husqvarna approved service agent.

- Do not change the safety devices.

## ON/OFF switch

The ON/OFF switch is used to start and stop the product.

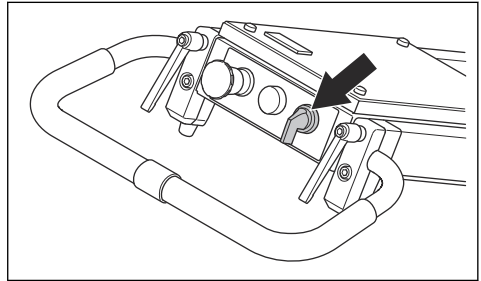

## To do a check of the ON/OFF switch

1. Turn the emergency stop button clockwise to make sure that emergency stop button is disengaged.

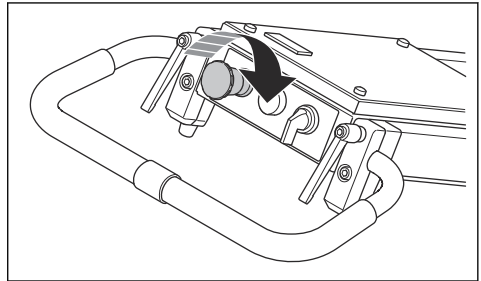

2. Push down the handle to lift the grinding head from the floor.

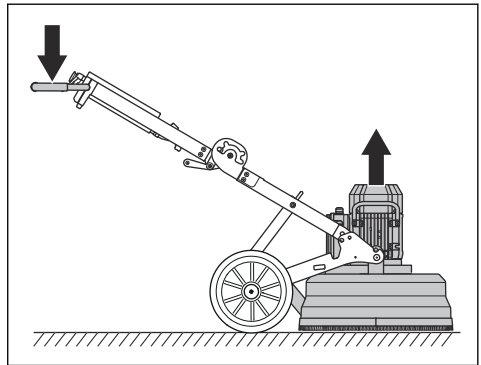

3. Turn the ON/OFF switch to 1 to start the product.

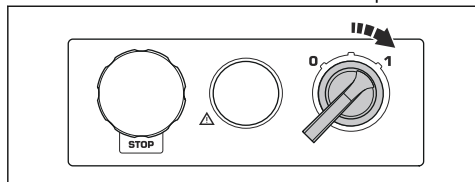

4. Wait for 5 seconds, this is to let the product operate at the idle speed.
5. Turn the ON/OFF switch to 0 to stop the product.

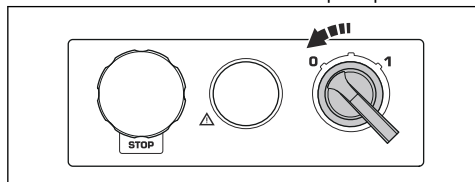

### Emergency stop

The emergency stop is used to quickly stop the motor. The emergency stop at the product breaks the mains power supply.

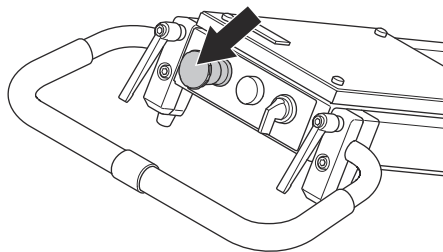

### To do a check of the emergency stop

1. Push the emergency stop button (A) and make sure that the motor stops.

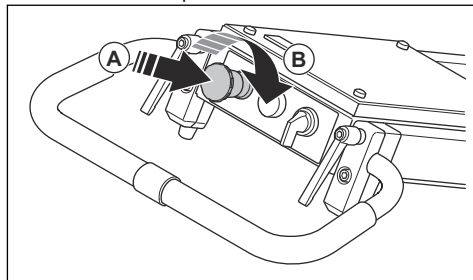

2. Turn the emergency stop button clockwise (B) to disengage.

### Safety instructions for maintenance

- Keep all parts in good condition and make sure that all fixtures are correctly tightened.
- Do not use a product that is defective. Do the safety checks, maintenance and the servicing as given in this manual. All other maintenance work must be done by an approved service agent.
- Stop the product when you replace the diamond tools. Turn the ON/OFF switch to 0 and push the emergency stop button.
- Do the inspection and/or maintenance with the motor stopped and the power plug disconnected.
- Do the maintenance to make sure that the product operates correctly. Refer to *Daily maintenance on page 13*

## Operation

### Introduction



**WARNING:** Before you operate the product, you must read and understand the safety chapter.

### Product positions

#### Operation position

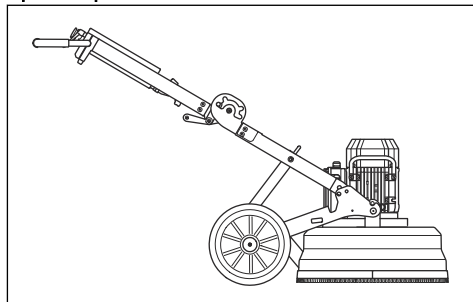

## Servicing position



**CAUTION:** Only put the product in the servicing position on a horizontal surface.

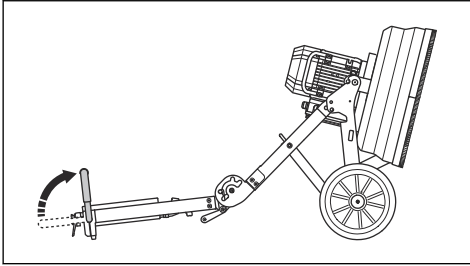

## Tilted transport position

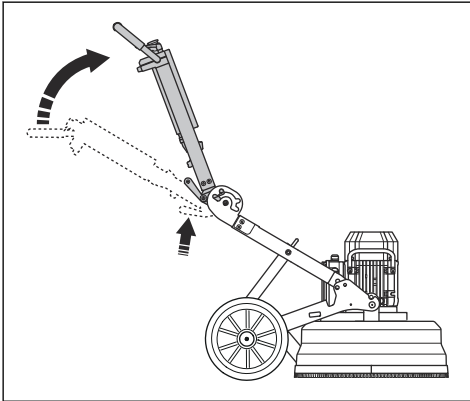

## Lift transport position

Put a protection between the motor and the electrical enclosure to prevent damage to the product.

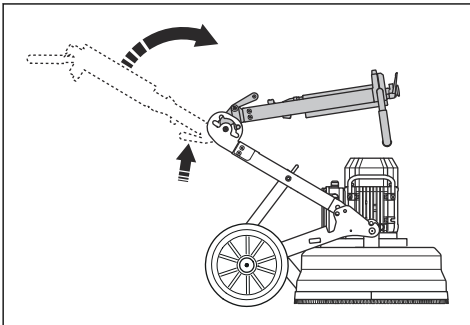

## To adjust the handlebar

The handle lock knobs are operated clockwise, counterclockwise or put in idle position.

1. Loosen the lock knobs (A) and adjust the handle (B) to idle position.

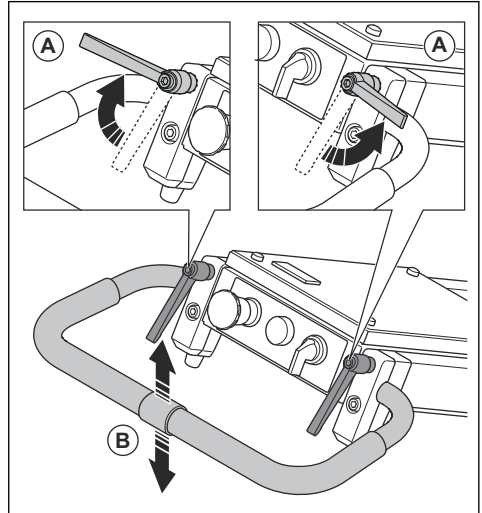

2. Tighten the lock knobs to set the position.
3. When the handle position is set, pull the handle lock knobs up (A) and put them into idle position (B).

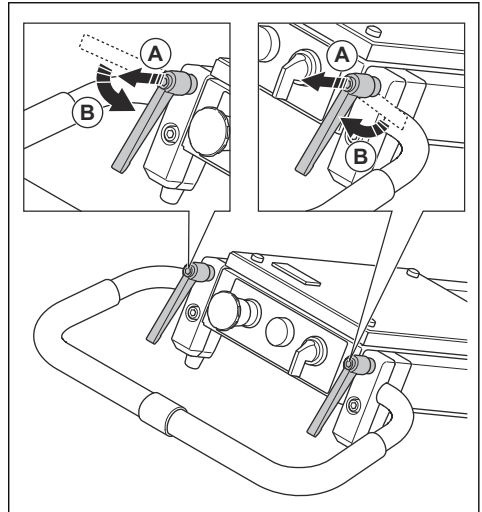

## To adjust the frame height

The angle of the frame can be changed to divide the weight of the chassis. This is to decrease or increase the grinding pressure against the surface.

Adjust the angle to set up a good work position for different operators.



1. Remove the lock knobs (A) to loosen the support foot (B).

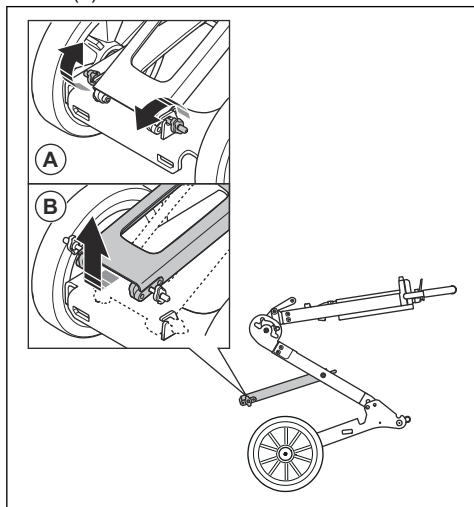

2. Hold the handlebar to keep the frame stable and lift the support foot out and up.

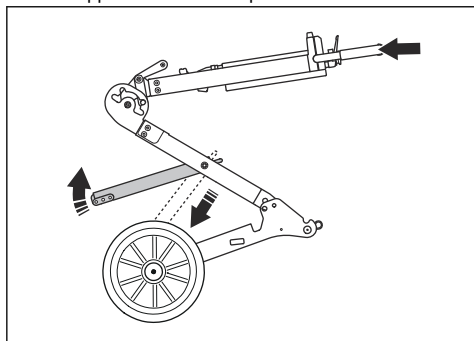

3. Select the applicable position for the operation and tighten the lock knob. The bottom hole increases the grinding pressure and the height of the handlebar. The top hole decreases the grinding pressure and the handlebar.

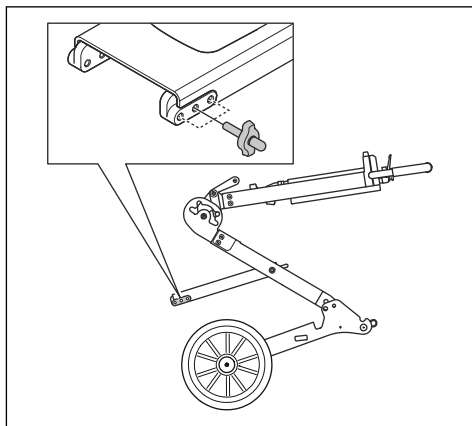

#### Handle heights

Hole position	Handle height, mm
Top	765
Center	870
Lower	960

#### Diamond tools

There are many types of diamond tools for the product. Speak to your approved service center or go to [www.husqvarnacp.com](http://www.husqvarnacp.com) to select correct diamond tool.

#### Installation of the diamond tools

The installation of the diamond tools on the tool plate has effect on the performance of the product. The diamond tool type together with the number of segments on the diamond tool is important.

Use metal bond diamond tools with 2 segments for usual grind operations, to make the surface level or light removal.

Use metal bond diamond tools with 1 diamond segment to increase the diamond tool pressure. This installation is for heavy removal with much force.

For the heaviest removal, we recommend to use tools that only run in one direction with PCD diamond tops.

**Note:** Piranha™ tools are made to run only in one direction.

## Metal bond diamond tools

**Note:** We recommend 3 tools with 1 segment on each Redi Lock® holder disc when you remove surface or usual concrete.

- Use Redi Lock® holder disc to attach metal bonded diamond tools.

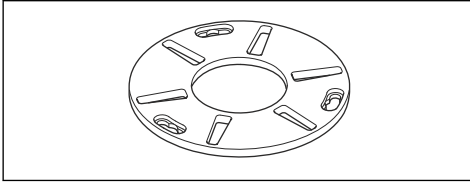

- A Redi Lock® holder disc with half set.

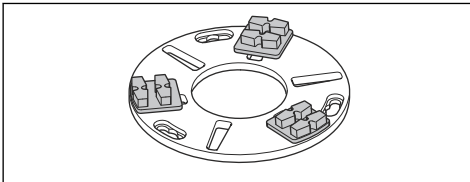

- Grinding head with half set on the 3 grinding discs.

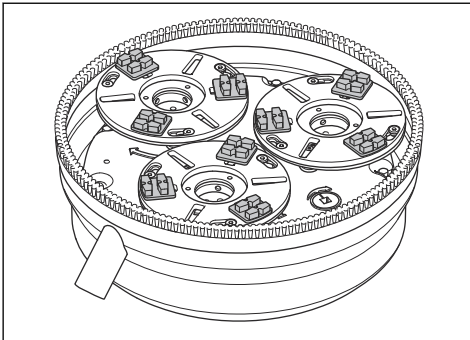

## Resin bond diamond tools

- Use resin holder disc to attach plastic bonded diamond tools.

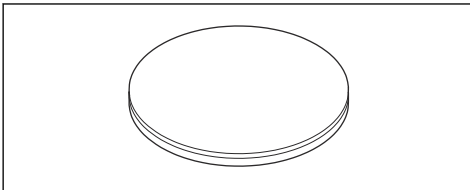

- Plastic bonded tool attached to resin holder disc.

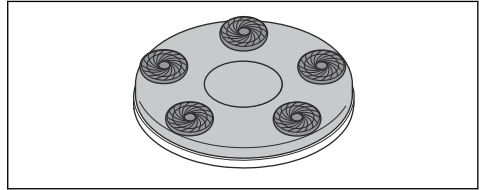

- Grinding head with 3 resin holder discs and tools

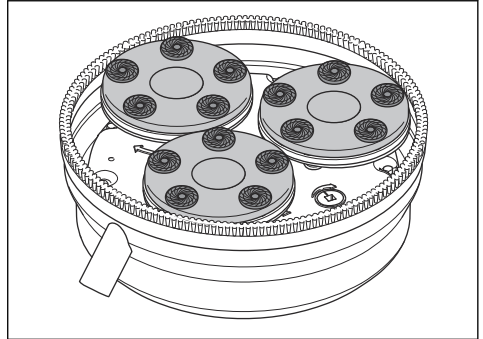

## To do before you operate the product

1. Read the operator's manual carefully and make sure that you understand the instructions.
2. Do daily maintenance. Refer to *Maintenance on page 13*.
3. Make sure that the product is assembled correctly and is not damaged.
4. Put the product on the work area.
5. Make sure that there are diamond tools on the tool plate and that they are tightly attached.
6. Connect the dust extractor to the product. Refer to *To connect a dust extractor on page 13*.
7. Adjust the handlebar to set the necessary work height.
8. Make sure that the motor cable is connected to the electrical enclosure before the product is connected to an electric socket.
9. Connect the power plug of the product into the mains outlet.

10. Turn the emergency stop button clockwise to make sure that the emergency stop is disengaged.

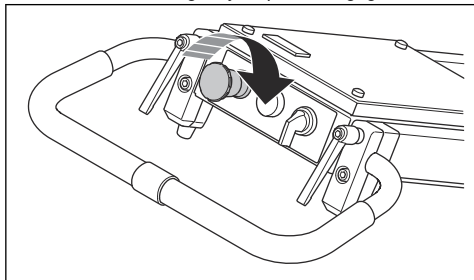

11. Make sure that you know in which direction the motor rotates.

### To change in which direction the motor rotates



**CAUTION:** The Piranha tools are made to rotate in only one direction.

1. Look at the arrow to see in which direction the motor rotates.

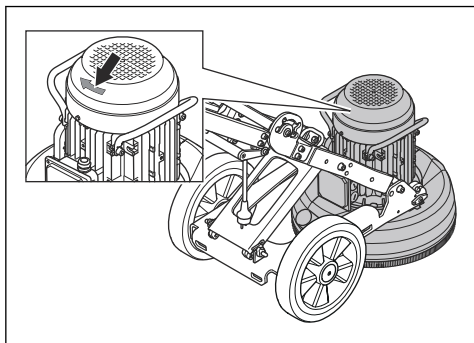

2. Turn the 2 pins in the power plug in the opposite direction to change in which direction the motor rotates. This is only applicable for 3-phase.

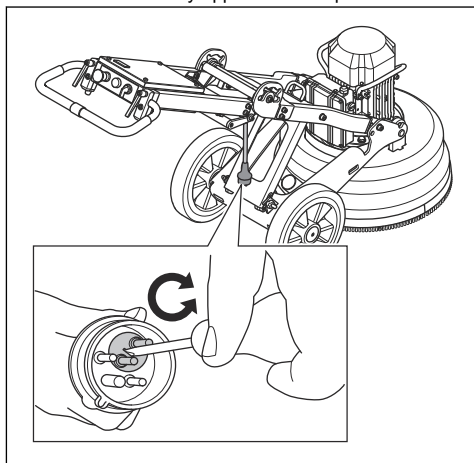

### To start the product

1. Push down the handle lightly to lift the grinding head from the surface, approximately 1 mm. This decreases the pressure against the surface. Do not lift the grinding head fully from the surface.

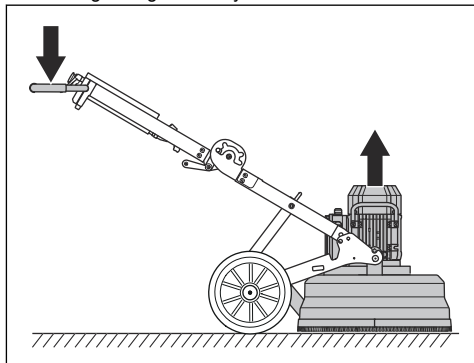

2. Turn the ON/OFF switch to 1 to start the product. In less than 5 seconds the product operates at the idle speed.

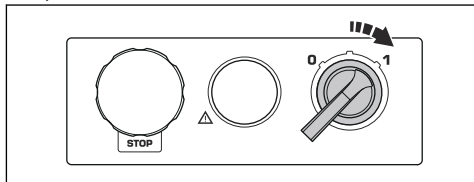

## To stop the product



**CAUTION:** Do not lift the tool plate from the surface when you stop the motor. The tool plate rotates for a while after the motor stops. Much off the dust can blow off in to the air and the surface can be damaged.



**CAUTION:** If you grind adhesive asphalt, paint or equivalent material, lift up the front of the product slightly when the tool plate stops. The product can attach to the adhesive surface if not lifted.

1. Turn the ON/OFF switch to 0 to stop the motor.

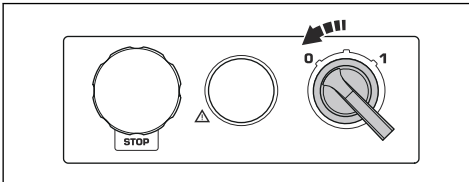

2. Keep the tool plate against the surface. Make sure that the tool plate does not rotate before you lift up the front.
3. Pull out the power plug.

## To replace the diamond tools



**WARNING:** Disconnect the power plug.



**WARNING:** Use protective gloves, as diamond tools can become very hot.

1. Turn the ON/OFF switch to 0 and disconnect the power plug to stop the product.

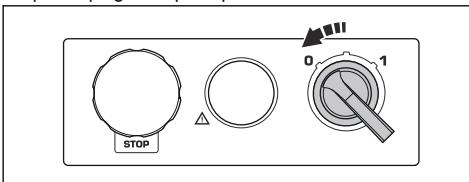

2. Push the emergency stop.

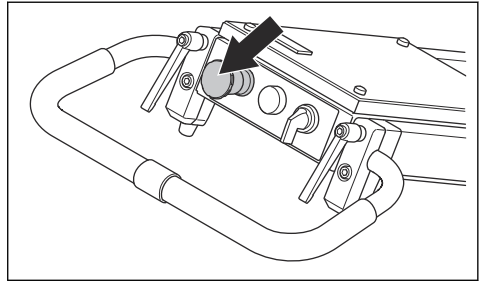

3. Put the product into servicing position.

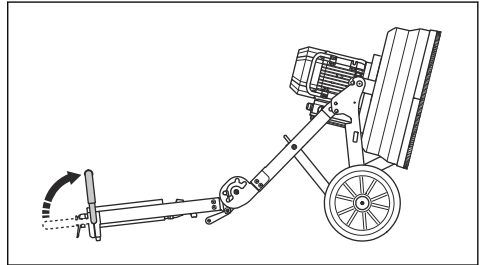

4. Use a hammer to remove the diamond tools.

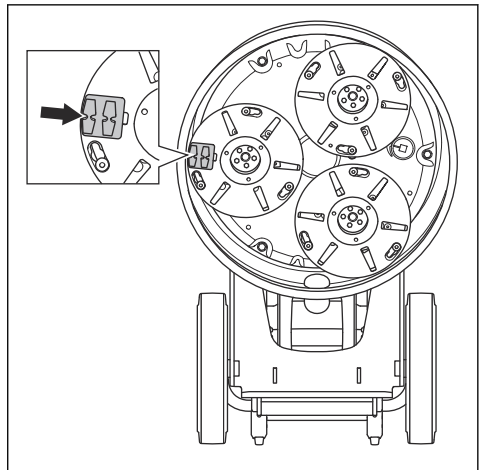

5. Attach new diamond tools on the tool plate.

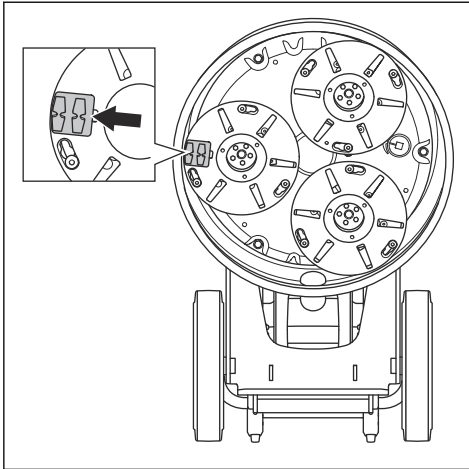

6. When the diamond tools are replaced, put the product into operation position.

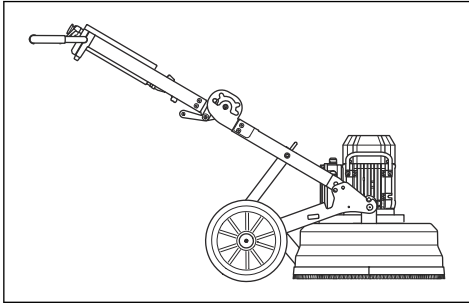

## To connect a dust extractor

Use a Husqvarna dust extractor system.

1. Connect the dust extractor to the product. Use a 50 mm (2 inch) hose.

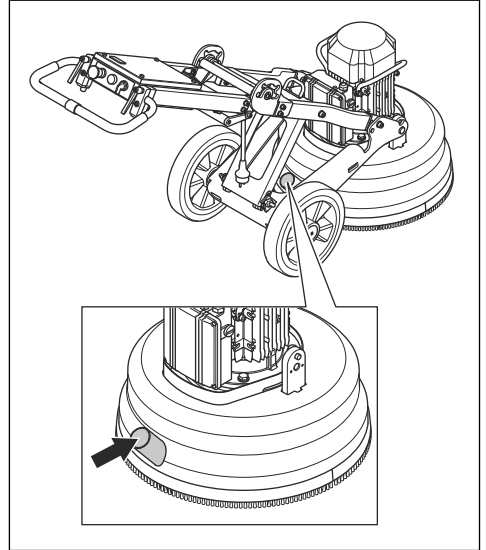

2. Make sure that the filters in the dust extractor are clean and not damaged. Monitor the dust during the operation.

## Maintenance

### Introduction



**WARNING:** Before you do maintenance, you must read and understand the safety chapter.

For all servicing and repair work on the product, special training is necessary. We guarantee the availability of professional repairs and servicing. If your dealer is not a service agent, speak to them for information about the nearest service agent.

### Daily maintenance

Daily maintenance means that you clean the product. Also that you do a check of the electrical supply, the brush strip and the grind holder.

### To clean the product



**CAUTION:** A blocked air intake decreases the performance of the product and can cause the motor to become too hot.

- Always pull out the plug from the mains outlet before you clean, do maintenance or assemble the product.
- Always clean all the equipment at the end of the work day. Do not use a high pressure washer to clean the product.
- Remove blockage from all air openings. The product must always have sufficiently cool temperature.

### To do a check of the electrical supply



**WARNING:** Do not use damaged cables. A damaged cable can cause serious injury or death.

- Make sure that the power cord and extension cable are not damaged and in good condition.
- Do not use the product if the power cord is damaged. Let an approved service center repair the product.

2. Examine the grind holder for damages and the wear of the rubber cylinders (C).
3. Replace the rubber cylinders if it is necessary.

### To do a check of the brush strip

- Make sure that the brush strip is full.
- Make sure that the brush strip touches the surface.

### To do a check of the grind holder



**CAUTION:** The condition of the grind holder is important for the performance and the safety.

1. Remove the grinding discs (A) and the tool plates (B).

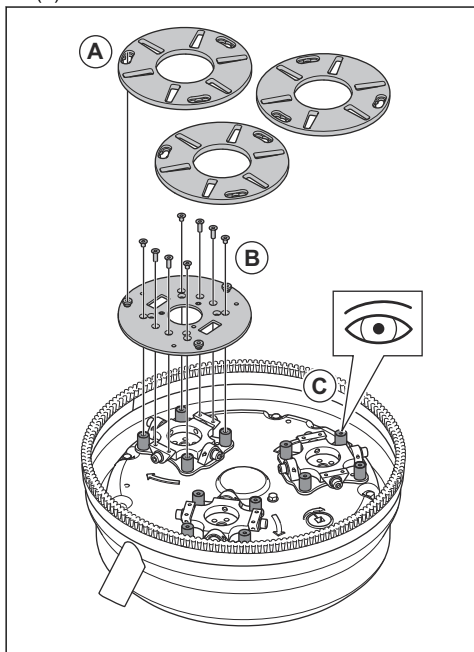

## Troubleshooting

### The product does not start

- Make sure that the power supply and the power cords are not damaged.
- Examine the emergency stop button, turn the button clockwise to release the emergency stop.
- Examine the overload lamp. If the overload lamp is on, let the motor cool down for some minutes until the product is automatically reset.

### The product is not easy to hold on to

- Too small number of diamond tools are installed on the product.
- The selected type of diamond tool is not correct for the surface.
- High current is used by the motor for the operation.
- Use the number of diamond tools that is recommended to decrease the force on the product and the operator. Refer to *Diamond tools* on page 9.

## The product has sudden movements

- Make sure that all diamond tools are installed correctly and that all have the same height.

## The product stops after only a while

- If the product overloads, the overload protection engages and stops the motor.
- Decrease the load. The lower hole is for a higher handlebar and increased grind pressure. The top hole is for a lower handlebar and decreased grind pressure.
- The product restarts after approximately a minute, when the temperature of the motor is decreased to usual level.

- Make sure that the extension cables are not too short.

## The product stops during startup

Correct voltage supply is necessary for a good motor performance. Too long extension cables and/or a too small gauge decreases the power of the motor during operation.

- If the motor overloads, the overload lamp comes on. Wait 2 minutes and try again. When this does not help, speak to an approved service workshop.
- Make sure that the extension cables are not too short.

---

## Transportation and storage

---

### To set the product in transport position

Put some type of protection on the product during transportation. The protection keeps natural elements such as rain and snow away from the product.

The product can be divided into 2 components. This makes the transportation easier.

Always move the product with the lifting eye and the handlebar.

1. Disconnect the motor cable from the electric enclosure (A).

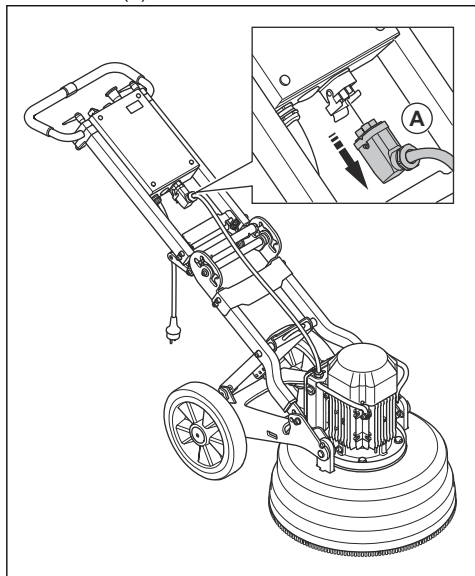

2. Pull out the lock pins (A) and remove the lock bolts (B) on each side of the grinding head

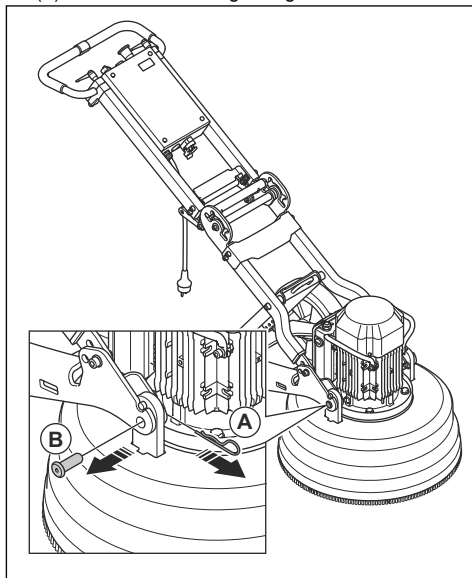

3. Remove the wheel chassis from the grinding head.

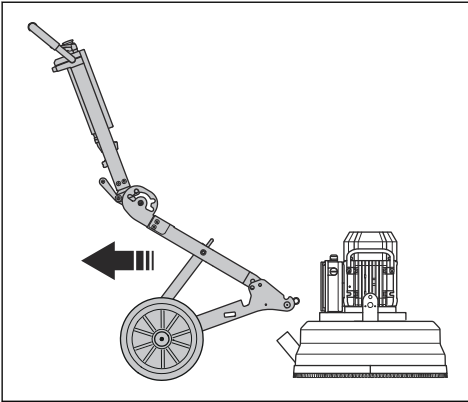

4. Push the handle on the central hinge and at the same time fold the top frame forward. The product is in the lift position.

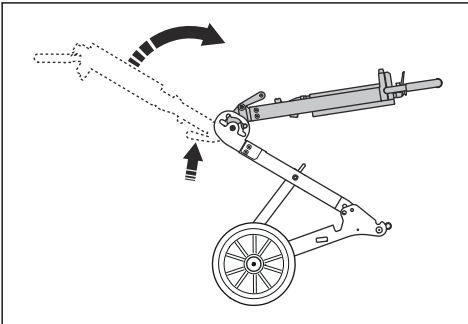

5. Remove the lock knobs (A) to loosen the support foot (B).

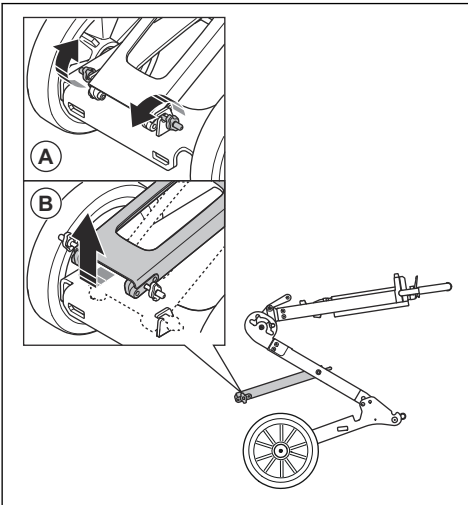

6. Hold the handlebar to keep the frame stable and lift the support foot out and up.

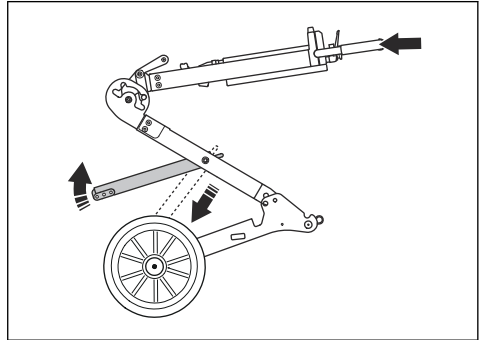

7. Hold the handlebar with one hand and push the handle on the central hinge. This folds the product into the folded position.

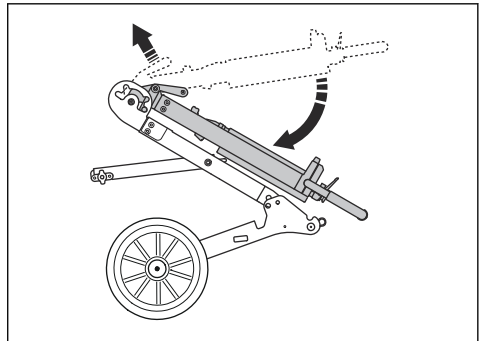

8. Fold the product carefully.

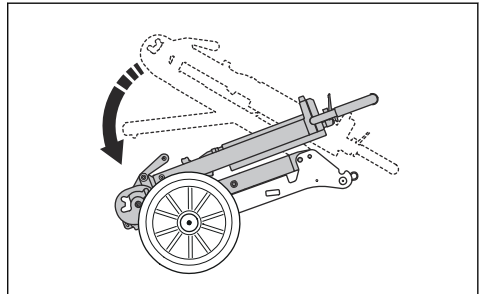



9. Move the lock pin and lock bolt from position (A) to position (B) to lock the product.

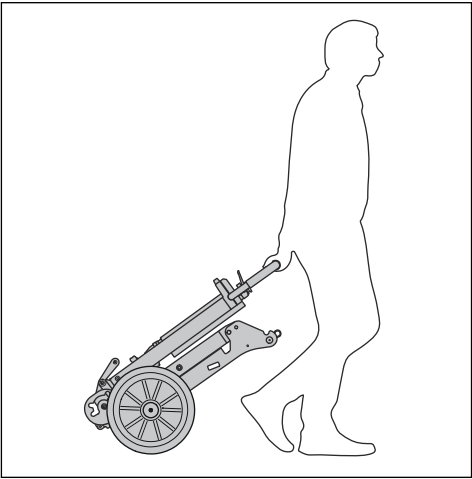
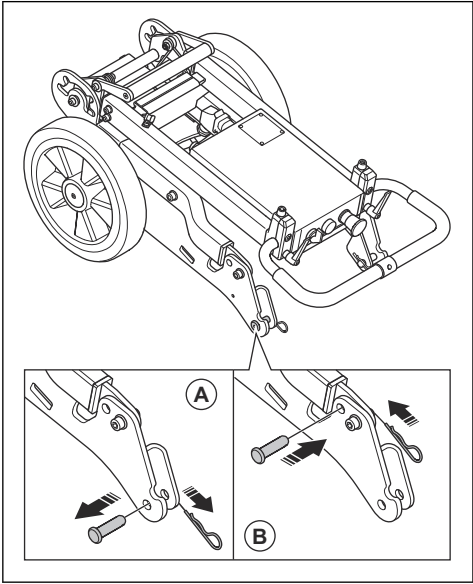

### Storage of the product

- Keep the product in a locked area to prevent access for children or persons that are not approved.
- Keep the product in a dry and frost free area.

## Technical data

### Technical data

	Three-phase, 380-420V	Three-phase, 440-480V	Three-phase, 220-240V	Single-phase, 220-240V	
Motor frequency, Hz	50	60	60	50	60
Motor power, kW/hp	4.0/5.4	4.0/5.4	4.0/5.4	2.2/3.0	3.0/4.0
Rated current, A	9	7	15	13	18
Rated voltage, V	380-420	440-480	220-240	220-240	220-240
Weight, kg/lbs	133/293	133/293	133/293	120/265	133/293
Grinding width, mm/in.	515/20.3	515/20.3	515/20.3	515/20.3	515/20.3
Grinding disc diameter, mm/in.	230/9	230/9	230/9	230/9	230/9
Grinding pressure, kg/lbs	79/174	79/174	79/174	66/145	80/176
Rotation speed - grinding discs, rpm	560	670	670	540	440

# Sound levels

	Three-phase, 380-420V	Three-phase, 440-480V	Three-phase, 220-240V	Single-phase, 220-240V	
Noise emissions <sup>1</sup> dB(A)					
Sound power level L <sub>WA</sub> (measured)	96	96	96	96	96
Sound levels <sup>2</sup> dB(A)					
Sound pressure level at the operators ear	81	81	81	81	81
Vibration levels <sup>3</sup> m/s <sup>2</sup>					
Right handle	1.3	1.3	1.3	1.3	1.3
Left handle	1.2	1.2	1.2	1.2	1.2

<sup>1</sup> Noise emission in the environment measured as sound power according to EN 60335-2-72. Expected measurement uncertainty 2,5 dB(A).

<sup>2</sup> Sound pressure level according to EN 60335-2-72. Expected measurement uncertainty 4 dB(A).

<sup>3</sup> Vibration level according to EN 60335-2-72. Reported data for vibration level has a typical statistical dispersion (standard deviation) of 1 m/s<sup>2</sup>

---

## EC Declaration of Conformity

---

### EC Declaration of Conformity

We, Husqvarna AB, SE-561 82 Huskvarna, Sweden, tel:  
+46- 36-146500, declare on our sole responsibility that  
the product:

Description	Polish & Grind Equipment
Brand	Husqvarna
Type/Model	PG 510
Identification	Serial numbers dating from 2019 and onwards

complies fully with the following EU directives and  
regulations:

Directive/Regulation	Description
2006/42/EC	"relating to machinery"
2011/65EU	"relating to restriction of hazardous substances"

and that the following standards and/or technical  
specifications are applied;

EN ISO 12100:2010

EN 60335-1:2012/A11:2014/A13:2017

EN 60335-2-72:2012

Partille, 10 April 2019

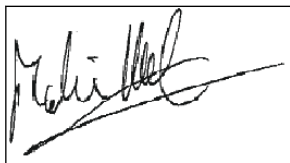

Martin Huber

Global R&D Director

Responsible for technical documentation





[www.husqvarnacp.com](http://www.husqvarnacp.com)

Original instructions  
Originalanweisungen  
Instructions d'origine  
Originele instructies

1141234-20



2019-05-13